

MOTORS FOR AIR HEATERS - EXTRACTORS

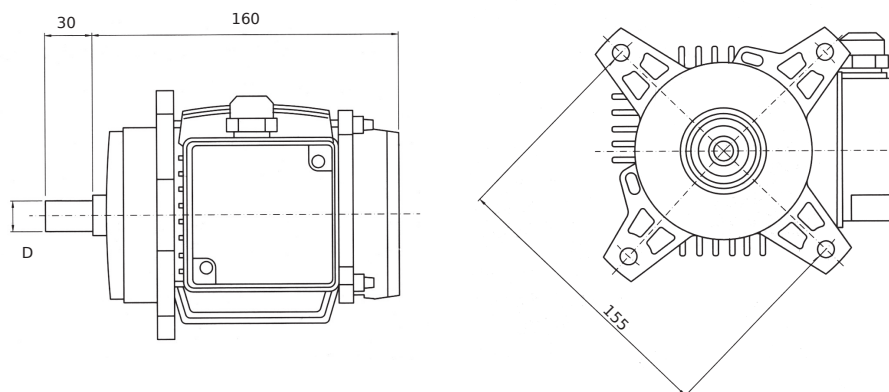
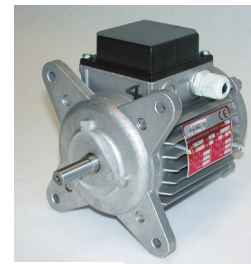

Ø SHAFT D	V	KW	N° POLES	rpm	CODE
12	230/400	0.18	4	1400	0402070
14	230/400	0.18	4	1400	0402071
12	230/400	0.11	6	900	0402072
14	230/400	0.11	6	900	0402073
12	230/400	0.12/0.07	4-6	1400/900	0402074
14	230/400	0.12/0.07	4-6	1400/900	0402075
12	230/400	0.12/0.05	4-8	1400/700	0402076
14	230/400	0.12/0.05	4-8	1400/700	0402077

TECHNICAL FEATURES:

Asynchronous, three-phase 50 Hz motor, insulation class F, IP54 protection level.